

# Inverness West Link- Proposed Alignment and Access Arrangements- April 2013

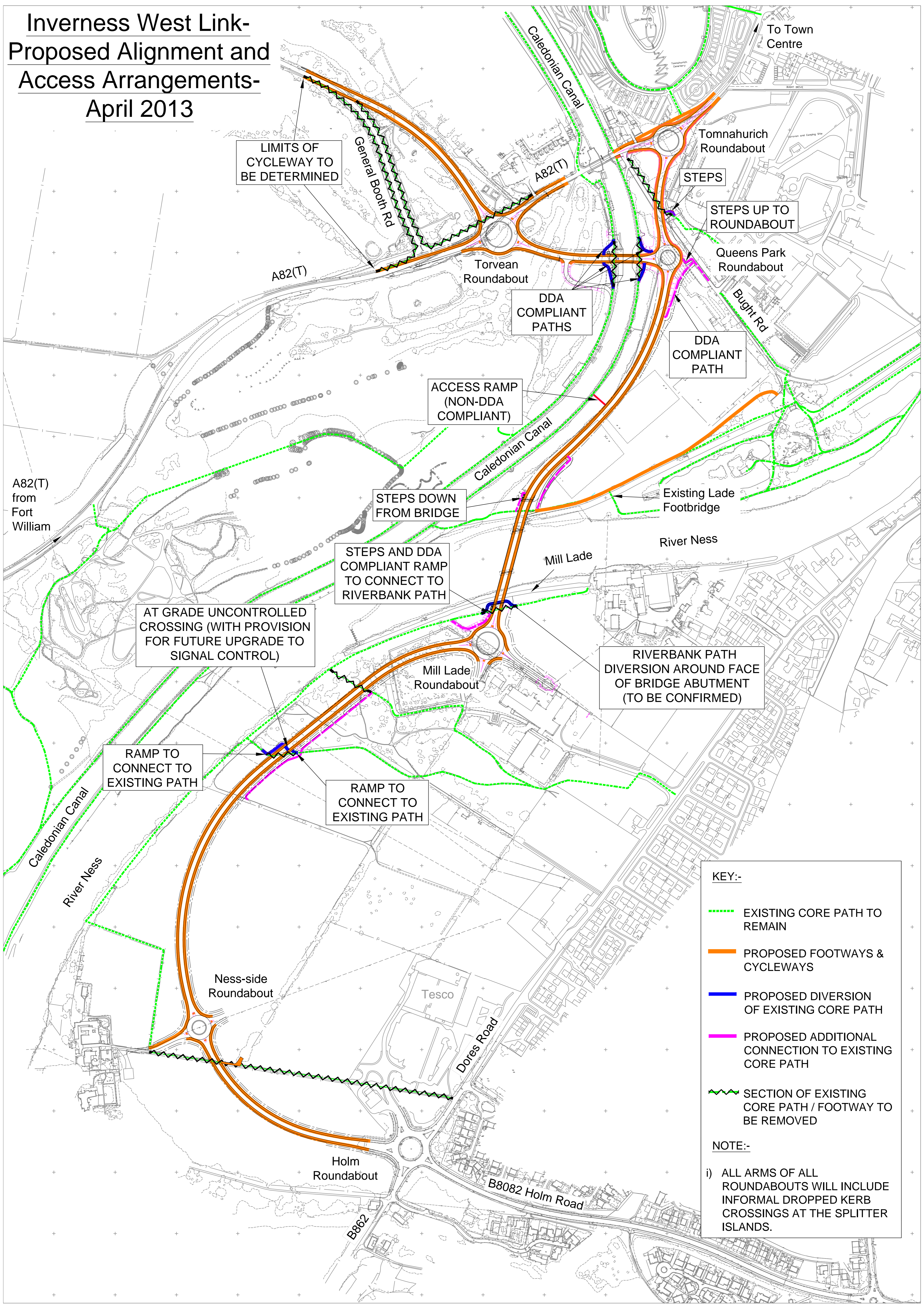

LIMITS OF CYCLEWAY TO BE DETERMINED

STEPS  
STEPS UP TO ROUNDABOUT

DDA COMPLIANT PATHS

DDA COMPLIANT PATH

ACCESS RAMP (NON-DDA COMPLIANT)

STEPS DOWN FROM BRIDGE

STEPS AND DDA COMPLIANT RAMP TO CONNECT TO RIVERBANK PATH

AT GRADE UNCONTROLLED CROSSING (WITH PROVISION FOR FUTURE UPGRADE TO SIGNAL CONTROL)

RIVERBANK PATH DIVERSION AROUND FACE OF BRIDGE ABUTMENT (TO BE CONFIRMED)

RAMP TO CONNECT TO EXISTING PATH

RAMP TO CONNECT TO EXISTING PATH

- KEY:-**
- EXISTING CORE PATH TO REMAIN
  - PROPOSED FOOTWAYS & CYCLEWAYS
  - PROPOSED DIVERSION OF EXISTING CORE PATH
  - PROPOSED ADDITIONAL CONNECTION TO EXISTING CORE PATH
  - /-/- SECTION OF EXISTING CORE PATH / FOOTWAY TO BE REMOVED

**NOTE:-**

i) ALL ARMS OF ALL ROUNDABOUTS WILL INCLUDE INFORMAL DROPPED KERB CROSSINGS AT THE SPLITTER ISLANDS.